

PRODUCT SHEET

Drivdon 75W/24V, DALI / Push dim



SELV Class 2

RoHS

(The certification icons represent on-going certification applications only, and final certification qualification is subject to actual products.)

DALI
Push DIM

0.1 %
Depth Dimming

V
Overvoltage
protection

Short circuit
protection

Overload
protection

Overheat
protection

Drivdon 75W/24V DALI/Push dim

ARTIKEL NR: 98LH2065

Wiring Diagram



Protective Housing Application Diagram

Tension plate

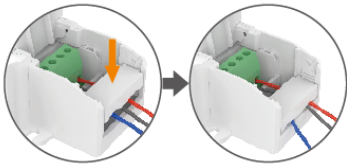

Push the tension plate down to fix the electric wires.



Push the side plate outwards and remove the tension plate by prying it up with a tool at the same time.

Remove the protective housing



Pull the bottom left and right from the bottom to remove it.